

SAFETY INFORMATION SHEET

BISCHOFFEN

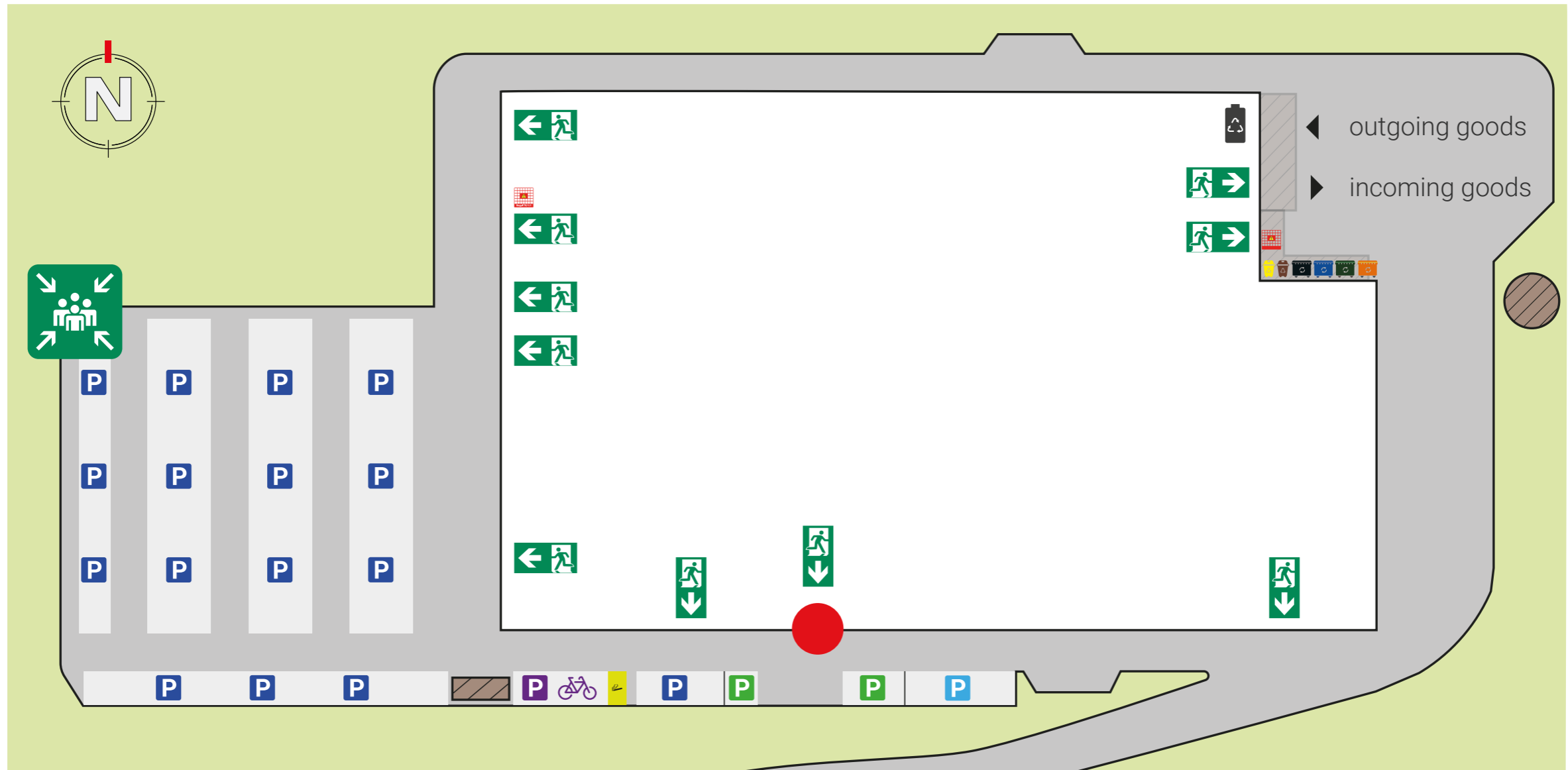

Site plan:



- | | | | | | |
|---|--|---|--|--|---|
|  Main entrance/
Your location |  Parking Lot Visitors |  E-Parking Lot |  Waste bins
Plastic |  Waste bins
Bio/Organic |  Battery Waste bins |
|  Smoking Area |  Parking Lot |  Bicycle garage
+ E-charging station |  Waste containers
Paper |  Waste containers
Wood |  Waste containers
Mixed waste |
|  Emergency Exit |  Assembly Point |  Waste containers
Foil |  Hazardous waste
(varnishes, paints) |  Hazardous waste Shelf 70/1/1
Electrical scrap, raw circuit boards, assembled circuit boards, cables
Hazardous waste (old solder/dross) | |

Welcome

Welcome to our production site in Bischoffen!

Your safety is our top priority. We would therefore like to draw your attention to important safety instructions and potential hazards. Please take a moment to read this information sheet carefully.

The entire site is barrier-free, including level car parks in the entrance area. We also offer a spacious bicycle garage with charging stations for e-bikes as well as parking spaces with charging stations for e-vehicles. Additional reserved customer car parks are also located near the entrance area.

Registration:

Please register at our reception desk, where they will provide you with all the information you need.

Please note:

The entire premises are under video surveillance 24/7.



We wish you a pleasant stay!

General information



Parking Lots

- German traffic regulations apply at our compound.
- The speed limit is 10 km/h
- Barrier-free parking lots are available in front of the entrance.
- Charging points for electric vehicles are available
- Make sure that your car is not leaking any liquids (e.g. diesel or oils).
- Please only park in the marked areas.
- Entrances and access roads for emergency vehicles must be kept clear at all times – please do not block them!
- In the event of emergency please render first aid to the best of your ability until trained responders arrive, and make every reasonable effort to rescue persons in need. Please report accidents or damages to Thermokon personnel.
- Fork lifts and delivery traffic has priority!



Assembly point

- In case of an alarm, please evacuate the building immediately via the marked emergency exits. Please gather to the meeting point. At the assembly point, please wait for further instructions. The emergency exits as well as the meeting points are shown on the back of the site plan.

General information



Production area / Warehouse:

- When entering the production area and/or warehouse please take care of goods stacked on the floor – risk of stumbling!
- Access to ESD protected areas is only permitted with appropriate footwear or ESD heel bands. Visitors are to be accompanied by Thermokon personnel in this area.
- Only use marked walkways and only enter areas through the designated wicket doors. Entering driveways and passing through hall gates is prohibited.
- The removal of company property must be authorised by the management or plant management. This also applies to production rejects!



Photography / Filming:

- Photography and filming is strictly prohibited.

General information



Smoking

- Smoking is only allowed outdoors at the designated smoking area.
- Cigarettes must be disposed of in the containers provided for this purpose.



Consumption of Alcohol and Drugs

- The consumption of alcohol, cannabis, cannabis-based products or other illegal drugs on company premises is prohibited.
- Entering the company premises under the influence of alcohol, cannabis or other illegal drugs is prohibited.

Behaviour in emergency situations



Fire: What to do?

- Report fire
Actuate fire alarm and/or dial phone number: 112
Who is reporting? / What happened? / How many people are in the building? / Location of fire? / Standby to answer questions!
- Get out of danger / move to a safe space
Take endangered persons with you / Close doors / Follow the marked emergency exits / Gather at the nearest meeting point, do not use an elevator / Wait for instructions
- Attempt to extinguish the fire
Use fire extinguishers when possible



Accidents: What to do?

- Report accident
Phone: 112
Where did the accident happen? / What happened? How many injured persons? / What kind of injuries? / Standby to answer questions!
- First aid
Secure the scene of the accident / Take care of the injured persons / Follow instructions
- Other measures
Direct ambulance or fire brigade / Disperse onlookers